

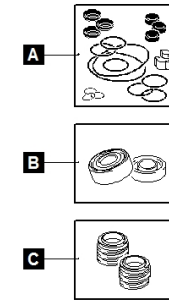

water solutions

0404.002 - SMP 1000/4/100 A0HT5 NGTAR8104YS00NN

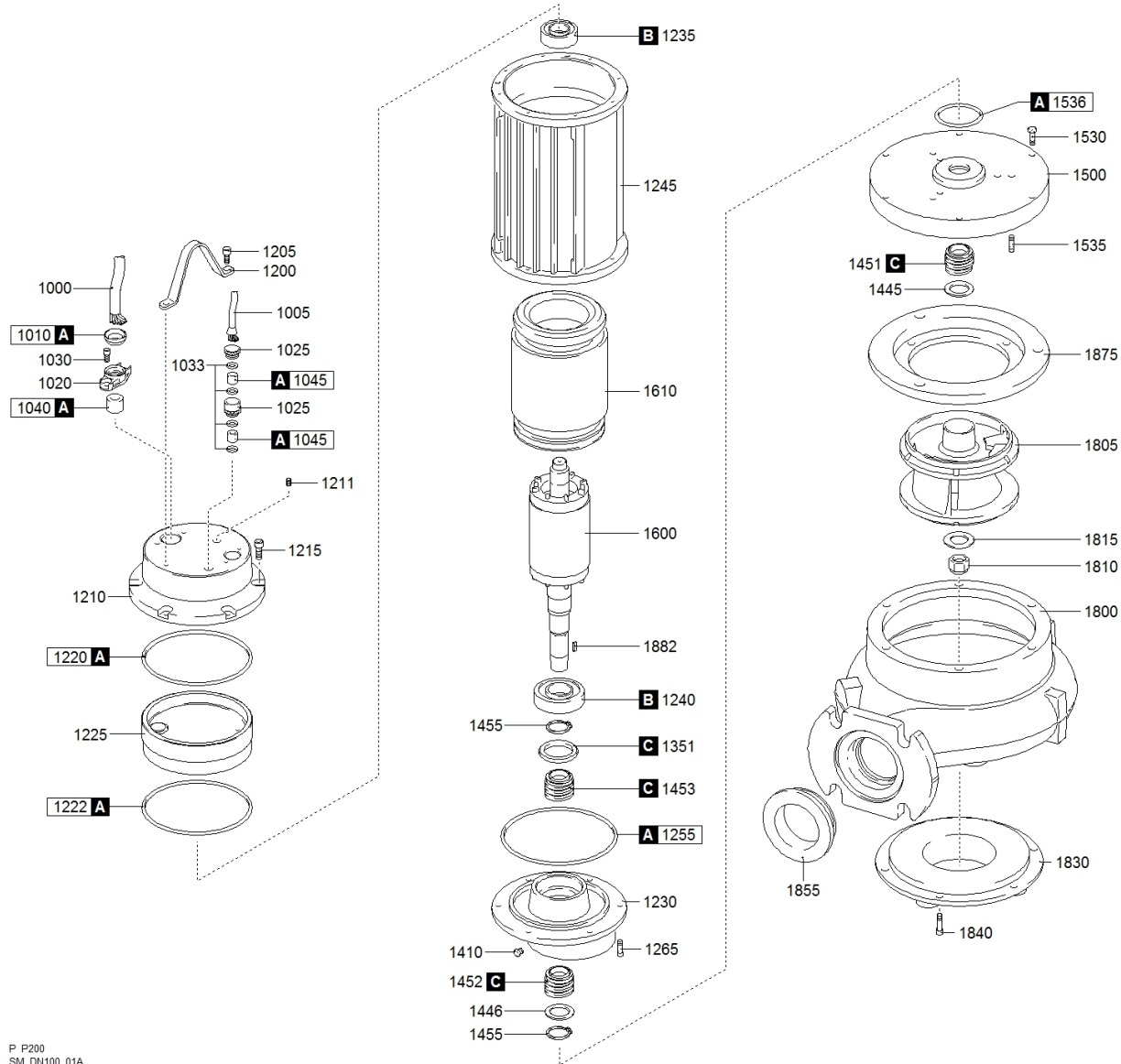



water solutions



0404.002 - SMP 1000/4/100 AOHT5 NGTAR8104YS00NN

	Code	Description	Q.ty
A	601018001	GASKETS KIT	1
C	602018101	MECHANICAL SEALS KIT	1
B	604021001	BEARINGS KIT	1
1000	25020270151000001	POWER CABLE	1
1010	235467418340	RING NUT [POWER CABLE]	1
1010	235467418340	RING NUT [POWER CABLE]	1
1020	235424418360	CABLE GLAND [POWER CABLE]	1
1020	235424418360	CABLE GLAND [POWER CABLE]	1
1030	270830810203200000	SCREW - CABLE GLAND [POWER CABLE]	6
1030	270831010203200000	SCREW - CABLE GLAND [POWER CABLE]	2
1030	270831010203200000	SCREW - CABLE GLAND [POWER CABLE]	2
1040	235673722855	RUBBER GASKET [POWER CABLE]	1
1040	235673722855	RUBBER GASKET [POWER CABLE]	1
1200	235233218400	HANDLE	1
1205	270831010203200000	SCREW [HANDLE >> COVER]	2
1210	232112317600	COVER	1
1211	270139530104000000	CAP [TIGHTNESS TEST]	1
1215	270830810203200000	SCREW [COVER >> MOTOR CASE]	6
1220	271770196035000000	GASKET [COVER >> UPPER BEARING HOLDER]	1
1225	230612318330	UPPER BEARING HOLDER	1
1230	230512300610	LOWER BEARING HOLDER	1
1235	2729063080200000	UPPER BEARING	1
1240	2729063080200000	LOWER BEARING	1
1245	231012300560	MOTOR CASE	1
1255	271770196035000000	GASKET [MOTOR CASE >> LOWER BEARING HOLDER]	1
1265	270830810253200000	SCREW [LOWER BEARING HOLDER >> MOTOR CASE]	6
1410	270149020081422818	CAP [OIL CHAMBER]	1
1445	270542221609011370	WASHER [1st MECHANICAL SEAL]	1
1446	270542221609011370	WASHER [2nd MECHANICAL SEAL]	1
1451	230000412300000000	1st MECHANICAL SEAL	1
1452	230000412300000000	2nd MECHANICAL SEAL	1
1453	230000000300000000	3th MECHANICAL SEAL	1
1455	270330300100000	SEEGER [1st MECHANICAL SEAL >> 2nd MECHANICAL SEAL]	1
1500	236212003001320	PUMP PLATE	1
1530	270830810201200000	SCREW [PUMP PLATE >> PUMP BODY]	6
1535	270830810201200000	SCREW [PUMP PLATE >> LOWER BEARING HOLDER]	6
1535	270830810301200000	SCREW [PUMP PLATE >> LOWER BEARING HOLDER]	6
1536	271770082026000000	GASKET [PUMP PLATE >> LOWER BEARING HOLDER]	1

1600	230230523215680	SHAFT WITH ROTOR	1
1610	230802323001000000	WOUND STATOR	1
1650	2790300422785	DATAPLATE	1
1655	273130000000	RIVET [DATAPLATE]	2
1800	21251026835519380	PUMP BODY	1
1805	21411303420917240	IMPELLER	1
1810	27073180932123771	LOCKING IMPELLER	1
1815	270531514302000000	LOCKING WASHER [IMPELLER]	1
1830	2162126823066	SUCTION FLANGE	1
1840	270830810203200000	SCREW [SUCTION FLANGE >> PUMP BODY]	6
1855	2750735403400	DISCHARGE GASKET	1
1875	236412683017220	HYDRAULIC UNION RING	1
1882	270430807035100000	KEY [IMPELLER]	1